

FOR INDEX OF SHEETS SEE SHEET 1B



COMMONWEALTH OF VIRGINIA
DEPARTMENT OF TRANSPORTATION

PLAN AND PROFILE OF PROPOSED
STATE HIGHWAY
COUNTY OF CHARLOTTE
FARMVILLE HIGHWAY
FROM: 0.055 MI. S. OF RTE. 15 BUS.
TO: 0.115 MI. N. OF RTE. 15 BUS.

FHWA 534 DATA 14021

STATE	FEDERAL AID	STATE		SHEET NO.
	PROJECT	ROUTE	PROJECT	
VA.	STP-0193(041) See Tabulation Below for Section Numbers	15	(NFO) 0015 - 019 - 859 (SEE TABULATION BELOW FOR SECTION NUMBERS)	1

FUNCTIONAL CLASSIFICATION AND TRAFFIC DATA	
RURAL MINOR ARTERIAL - ROLLING - 30 MPH MIN. DESIGN SPEED	
	Fr: 0.055 MI. S. OF RTE. 15 BUS. To: 0.115 MI. N. OF RTE. 15 BUS.
ADT	4,586 (2018)
ADT	5,779 (2044)
DHV	694
D (%) (design hour)	50/50
T (%) (design hour)	6.62%
V (MPH)	SEE PLAN AND PROFILE SHEETS FOR DESIGN SPEEDS.

PUBLIC HEARING PLANS

THESE PLANS ARE UNFINISHED AND UNAPPROVED AND ARE NOT TO BE USED FOR ANY TYPE OF CONSTRUCTION OR THE ACQUISITION OF RIGHT OF WAY.

PRELIMINARY EASEMENTS FOR UTILITY RELOCATIONS ARE APPROXIMATE ONLY AND SUBJECT TO CHANGE AS PROJECT DESIGN IS FINALIZED

ADDITIONAL EASEMENTS FOR UTILITY RELOCATIONS MAY BE REQUIRED BEYOND THE PROPOSED RIGHT-OF-WAY SHOWN ON THESE PLANS.

PROJECT MANAGER Anthony Revelle (434) 856-8258
SURVEYED BY, DATE Daniel J. Brown, PE (434) 856-8265
DESIGN BY Daniel J. Brown, PE (434) 856-8265
SUBSURFACE UTILITY BY, DATE Rayford T. Clark, LS (434) 856-8262
LYNCHBURG DISTRICT DESIGN UNIT

CONVENTIONAL SIGNS

STATE LINE	-----
COUNTY LINE	-----
CITY/TOWN OR VILLAGE	-----
RIGHT OF WAY LINE	-----
FENCE LINE	-----
UNFENCED PROPERTY LINE	-----
FENCED PROPERTY LINE	-----
WATER LINE	-----
SANITARY SEWER LINE	-----
GAS LINE	-----
ELECTRIC UNDERGROUND CABLE	-----
TRAVELED WAY	-----
GUARD RAIL	-----
RETAINING WALL	-----
RAILROADS	-----
BASE OR SURVEY LINE	-----
LEVEE OR EMBANKMENT	-----
BRIDGES	-----
CULVERTS	-----
DROP INLET	-----
POWER POLES	-----
TELEPHONE OR TELEGRAPH POLES	-----
TELEPHONE OR TELEGRAPH LINES	-----
HEDGE	-----
TREES	-----
HEAVY WOODS	-----
GROUND ELEVATION	-----
GRADE ELEVATION	-----

THE COMPLETE ELECTRONIC PDF VERSION OF THE PLAN ASSEMBLY AS AWARDED, HAS BEEN SEALED AND SIGNED USING DIGITAL SIGNATURES AND THE OFFICIAL PLAN ASSEMBLY IN ELECTRONIC FORMAT IS STORED IN THE VDOT CENTRAL OFFICE PLAN LIBRARY, INCLUDING ALL SUBSEQUENT REVISIONS, WILL BE THE OFFICIAL CONSTRUCTION PLANS. FOR INFORMATION RELATIVE TO ELECTRONIC FILES AND LAYERED PLANS, SEE THE GENERAL NOTES.

DESIGN FEATURES RELATING TO CONSTRUCTION OR TO REGULATION AND CONTROL OF TRAFFIC MAY BE SUBJECT TO CHANGE AS DEEMED NECESSARY BY THE DEPARTMENT.

THIS PROJECT IS TO BE CONSTRUCTED IN ACCORDANCE WITH THE DEPARTMENT'S 2020 ROAD AND BRIDGE SPECIFICATIONS, 2016 ROAD AND BRIDGE STANDARDS, 2009 MUTCD, 2011 VIRGINIA SUPPLEMENT TO THE MUTCD, 2011 VIRGINIA WORK AREA PROTECTION MANUAL AND AS AMENDED BY CONTRACT PROVISIONS AND THE COMPLETE ELECTRONIC PDF VERSION OF THE PLAN ASSEMBLY.

ALL CURVES ARE TO BE SUPERELEVATED, TRANSITIONED AND WIDENED IN ACCORDANCE WITH STANDARD TC-5.11R, EXCEPT WHERE OTHERWISE NOTED.

THE ORIGINAL APPROVED TITLE SHEET(S), INCLUDING ORIGINAL SIGNATURES, ARE FILED IN THE VDOT CENTRAL OFFICE PLAN LIBRARY. ANY MISUSE OF ELECTRONIC FILES, INCLUDING SCANNED SIGNATURES, IS ILLEGAL AND ENFORCED TO THE FULL EXTENT OF THE LAW.

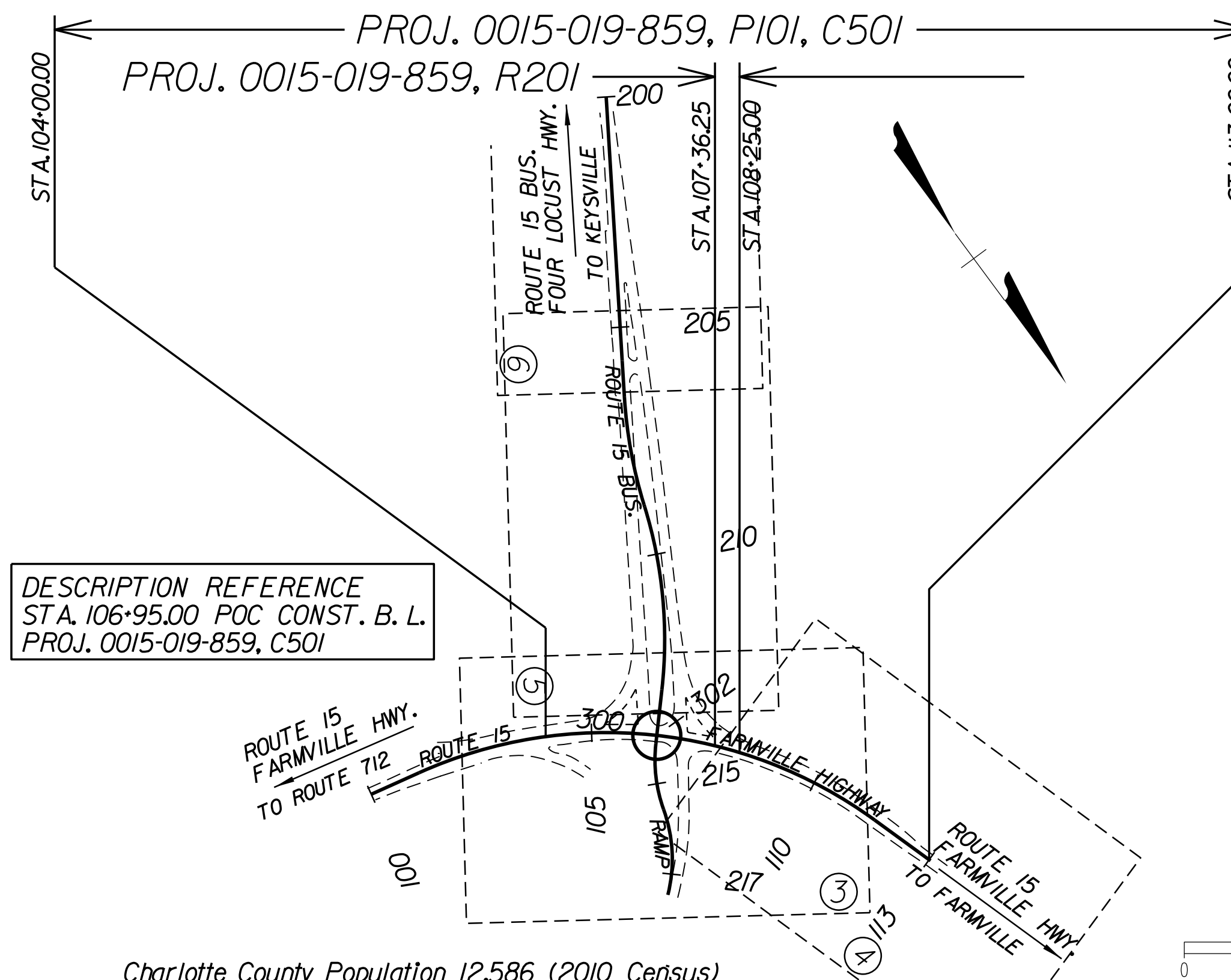

DESCRIPTION REFERENCE
STA. 106+95.00 POC CONST. B. L.
PROJ. 0015-019-859, C501

Charlotte County Population 12,586 (2010 Census)

STATE PROJECT NO.	SECTION	FEDERAL AID PROJECT NO.	TYPE CODE	UPC NO.	EQUALITIES	LENGTH INCLUDING BRIDGE(S)		LENGTH EXCLUDING BRIDGE(S)		BRIDGE PLAN NO.	TYPE PROJECT	DESCRIPTION
					FEET	FEET	MILES	FEET	MILES			
0015-019-859	PI01	STP-0193(041)		110767	NONE			900	0.170		PREL. ENGR.	FROM: 0.055 MI. S. OF RTE. 15 BUS. TO: 0.115 MI. N. OF RTE. 15 BUS.
	R201			110767	NONE			88.75	0.017		RIGHT OF WAY	FROM: 0.008 MI. N. OF RTE. 15 BUS. TO: 0.025 MI. N. OF RTE. 15 BUS.
	C501		1000	110767	NONE			900	0.170		PAVEMENT, GRADING & DRAINAGE	FROM: 0.055 MI. S. OF RTE. 15 BUS. TO: 0.115 MI. N. OF RTE. 15 BUS.

PROJECT LENGTH BASED ON ROUTE 15 CONSTRUCTION BASELINE

TIER 1 PROJECT

RECOMMENDED FOR APPROVAL FOR RIGHT OF WAY ACQUISITION

DATE	DISTRICT PLANNING AND INVESTMENT MANAGER
------	--

DATE	DISTRICT PROJECT DEVELOPMENT ENGINEER
------	---------------------------------------

APPROVED FOR RIGHT OF WAY ACQUISITION

DATE	DISTRICT ENGINEER/ADMINISTRATOR
------	---------------------------------

RECOMMENDED FOR APPROVAL FOR CONSTRUCTION

DATE	DISTRICT PLANNING AND INVESTMENT MANAGER
------	--

DATE	DISTRICT PROJECT DEVELOPMENT ENGINEER
------	---------------------------------------

APPROVED FOR CONSTRUCTION

DATE	DISTRICT ENGINEER/ADMINISTRATOR
------	---------------------------------

Copyright 20 , Commonwealth of Virginia

PROJECT MANAGER **Anthony Revelle (434) 856-8258**
 SURVEYED BY, DATE **Rayford T. Clark, LS (434) 856-8262**
 DESIGN BY **Daniel J. Brown, PE (434) 856-8265**
 SUBSURFACE UTILITY BY, DATE **Rayford T. Clark, LS (434) 856-8262**
 LYNCHBURG DISTRICT DESIGN UNIT

REVISED	STATE	ROUTE	STATE PROJECT	SHEET NO.
	VA.	15	0015-019-859 P101, R201, C501	3

DESIGN FEATURES RELATING TO CONSTRUCTION OR TO REGULATION AND CONTROL OF TRAFFIC MAY BE SUBJECT TO CHANGE AS DEEMED NECESSARY BY THE DEPARTMENT

VDOT Lynchburg District
Lynchburg, Virginia
ROADWAY ENGINEER

VDOT Lynchburg District
Lynchburg, Virginia
HYDRAULICS ENGINEER

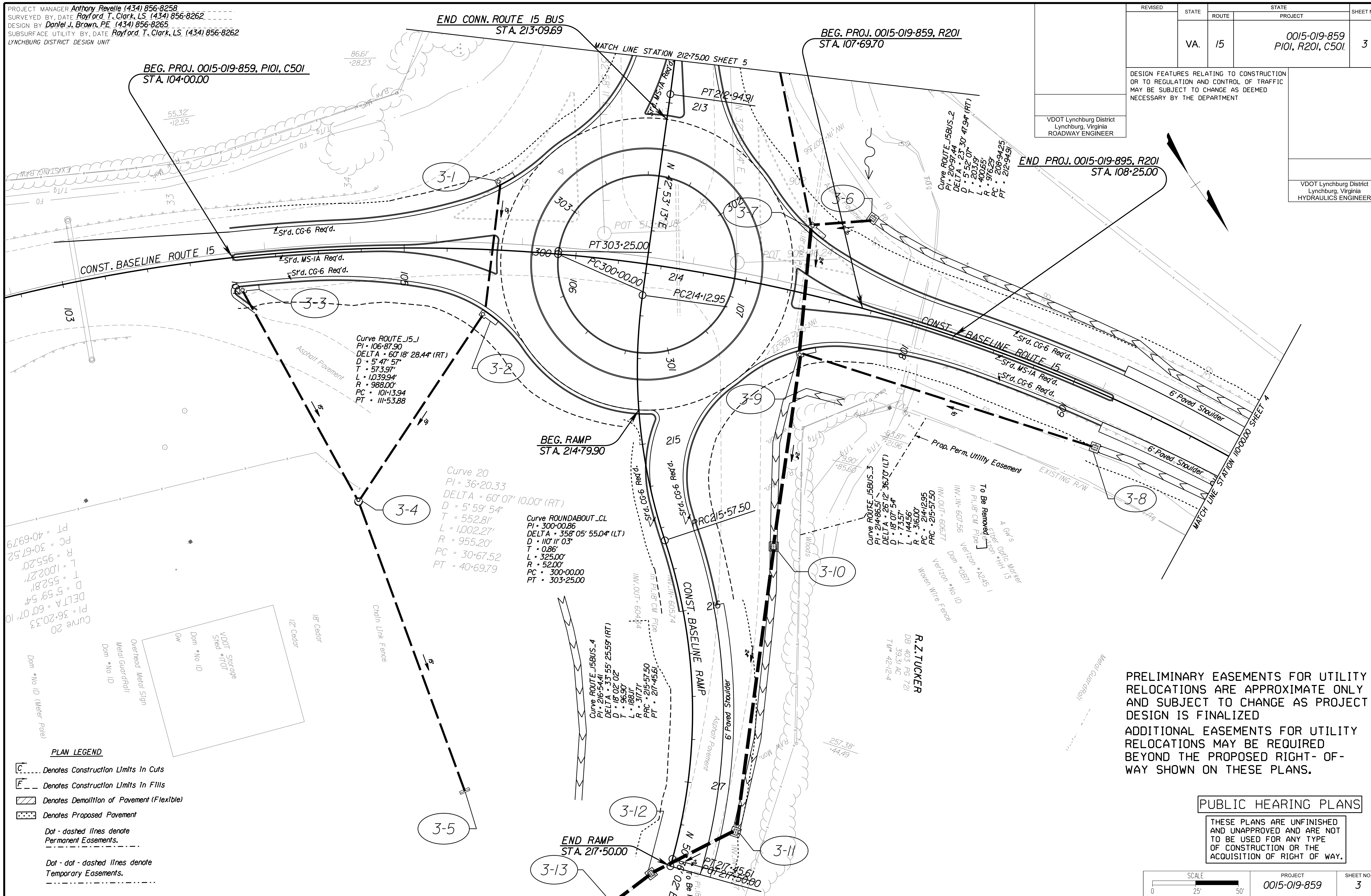

Curve 20
PI = 36+20.33
DELTA = 60° 07' 10.00" (RT)
D = 5' 59' 54"
T = 552.81'
L = 1,002.27'
R = 955.20'
PC = 30+67.52
PT = 40+69.79

Curve ROUTE 15.J
PI = 106+87.90
DELTA = 60° 18' 28.44" (RT)
D = 5' 47' 57"
T = 573.97'
L = 1,039.94'
R = 988.00'
PC = 101+13.94
PT = 111+53.88

Curve 20
PI = 36+20.33
DELTA = 60° 07' 10.00" (RT)
D = 5' 59' 54"
T = 552.81'
L = 1,002.27'
R = 955.20'
PC = 30+67.52
PT = 40+69.79

Curve ROUNDABOUT_CL
PI = 300+00.86
DELTA = 358° 05' 55.04" (LT)
D = 110' 11" 03"
T = 0.86'
L = 325.00'
R = 52.00'
PC = 300+00.00
PT = 303+25.00

Curve ROUTE 15BUS-3
PI = 214+86.51
DELTA = 26° 12' 36.70" (LT)
D = 18' 07' 54"
T = 73.57'
L = 144.56'
R = 316.00'
PC = 214+12.95
PT = 215+57.50

Curve ROUTE 15BUS-4
PI = 216+54.41
DELTA = 33° 55' 25.59" (RT)
D = 18' 02' 02"
T = 96.90'
L = 188.71'
R = 317.11'
PC = 215+57.50
PT = 217+45.61

R. Z. TUCKER
DB 403 PG 721
39.31 AC
TM = 42-12-4

PLAN LEGEND

- Denotes Construction Limits in Cuts
- Denotes Construction Limits in Fills
- Denotes Demolition of Pavement (Flexible)
- Denotes Proposed Pavement
- Dot - dashed lines denote Permanent Easements.
- Dot - dot - dashed lines denote Temporary Easements.

PRELIMINARY EASEMENTS FOR UTILITY RELOCATIONS ARE APPROXIMATE ONLY AND SUBJECT TO CHANGE AS PROJECT DESIGN IS FINALIZED

ADDITIONAL EASEMENTS FOR UTILITY RELOCATIONS MAY BE REQUIRED BEYOND THE PROPOSED RIGHT- OF- WAY SHOWN ON THESE PLANS.

PUBLIC HEARING PLANS

THESE PLANS ARE UNFINISHED AND UNAPPROVED AND ARE NOT TO BE USED FOR ANY TYPE OF CONSTRUCTION OR THE ACQUISITION OF RIGHT OF WAY.

PROJECT MANAGER **Anthony Revelle (434) 856-8258**
 SURVEYED BY, DATE **Rayford T. Clark, LS (434) 856-8262**
 DESIGN BY **Daniel J. Brown, PE (434) 856-8265**
 SUBSURFACE UTILITY BY, DATE **Rayford T. Clark, LS (434) 856-8262**
 LYNCHBURG DISTRICT DESIGN UNIT

REVISED	STATE	STATE		SHEET NO.
	ROUTE	PROJECT		
	VA.	15	0015-019-859 P101, C501	4
DESIGN FEATURES RELATING TO CONSTRUCTION OR TO REGULATION AND CONTROL OF TRAFFIC MAY BE SUBJECT TO CHANGE AS DEEMED NECESSARY BY THE DEPARTMENT				
VDOT Location & Design Lynchburg, Virginia ROADWAY ENGINEER		VDOT Location & Design Lynchburg Virginia HYDRAULIC ENGINEER		

R.Z. TUCKER
DARA B. TUCKER
 DB 383 PG 321
 111.62 AC
 TM* 42-A-66-1

END PROJ. 0015-019-895, P101, C501
 STA. 113+00.00

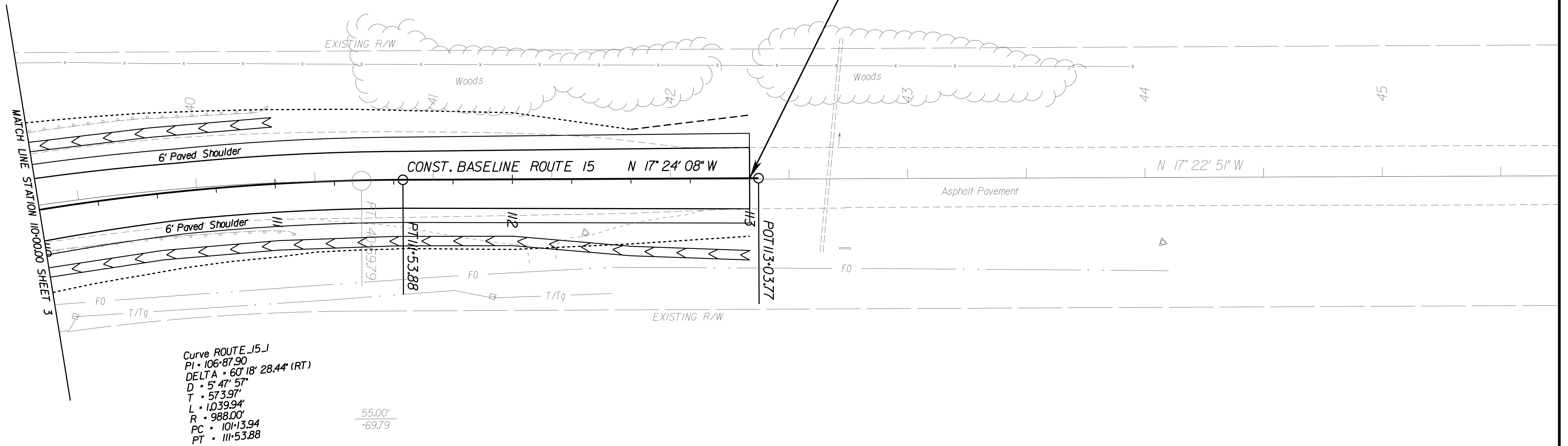

Curve ROUTE_15.J
 PI = 106+87.90
 DELTA = 60° 18' 28.44" (RT)
 D = 5' 47' 57"
 T = 573.97'
 L = 1,039.94'
 R = 988.00'
 PC = 101+13.94
 PT = 111+53.88

Curve 20
 PI = 36+20.33
 DELTA = 60° 07' 10.00" (RT)
 D = 5' 59' 54"
 T = 552.81'
 L = 1,002.27'
 R = 955.20'
 PC = 30+67.52
 PT = 40+69.79

R.Z. TUCKER
 DB 403 PG 721
 39.31 AC
 TM* 42-12-4

PRELIMINARY EASEMENTS FOR UTILITY RELOCATIONS ARE APPROXIMATE ONLY AND SUBJECT TO CHANGE AS PROJECT DESIGN IS FINALIZED

ADDITIONAL EASEMENTS FOR UTILITY RELOCATIONS MAY BE REQUIRED BEYOND THE PROPOSED RIGHT- OF-WAY SHOWN ON THESE PLANS.

PUBLIC HEARING PLANS

THESE PLANS ARE UNFINISHED AND UNAPPROVED AND ARE NOT TO BE USED FOR ANY TYPE OF CONSTRUCTION OR THE ACQUISITION OF RIGHT OF WAY.

- PLAN LEGEND**
- Denotes Construction Limits in Cuts
 - Denotes Construction Limits in Fills
 - Denotes Demolition of Pavement (Flexible)
 - Denotes Proposed Pavement
 - Dot - dashed lines denote Permanent Easements.
 - Dot - dot - dashed lines denote Temporary Easements.

PROJECT MANAGER **Anthony Revelle (434) 856-8258**
 SURVEYED BY, DATE **Rayford T. Clark, LS (434) 856-8262**
 DESIGN BY **Daniel J. Brown, PE (434) 856-8265**
 SUBSURFACE UTILITY BY, DATE **Rayford T. Clark, LS (434) 856-8262**
 LYNCHBURG DISTRICT DESIGN UNIT

PRELIMINARY EASEMENTS FOR UTILITY RELOCATIONS ARE APPROXIMATE ONLY AND SUBJECT TO CHANGE AS PROJECT DESIGN IS FINALIZED
 ADDITIONAL EASEMENTS FOR UTILITY RELOCATIONS MAY BE REQUIRED BEYOND THE PROPOSED RIGHT-OF-WAY SHOWN ON THESE PLANS.

REVISED	STATE	STATE	SHEET NO.
	VA.	ROUTE 15	
VDOT Location & Design Lynchburg, Virginia ROADWAY ENGINEER		VDOT Location & Design Lynchburg, Virginia HYDRAULIC ENGINEER	
DESIGN FEATURES RELATING TO CONSTRUCTION OR TO REGULATION AND CONTROL OF TRAFFIC MAY BE SUBJECT TO CHANGE AS DEEMED NECESSARY BY THE DEPARTMENT			

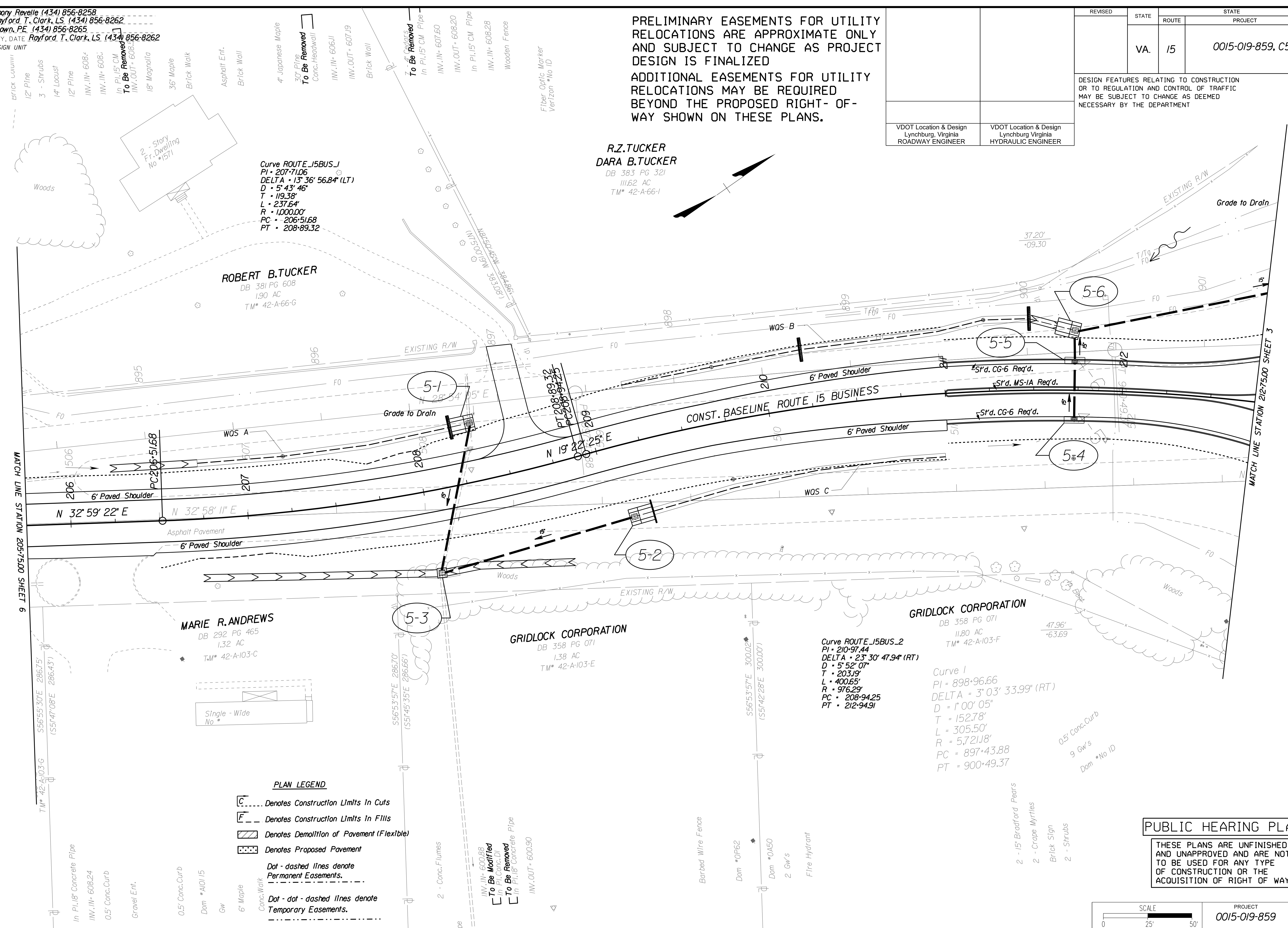

PLAN LEGEND

- Denotes Construction Limits In Cuts
- Denotes Construction Limits In Fills
- Denotes Demolition of Pavement (Flexible)
- Denotes Proposed Pavement
- Dot - dashed lines denote Permanent Easements.
- Dot - dot - dashed lines denote Temporary Easements.

PUBLIC HEARING PLANS

THESE PLANS ARE UNFINISHED AND UNAPPROVED AND ARE NOT TO BE USED FOR ANY TYPE OF CONSTRUCTION OR THE ACQUISITION OF RIGHT OF WAY.

PROJECT MANAGER **Anthony Reville (434) 856-8258**
 SURVEYED BY, DATE **Royford T. Clark, LS (434) 856-8262**
 DESIGN BY **Daniel J. Brown, PE (434) 856-8265**
 SUBSURFACE UTILITY BY, DATE **Royford T. Clark, LS (434) 856-8262**
 LYNCHBURG DISTRICT DESIGN UNIT

PRELIMINARY EASEMENTS FOR UTILITY RELOCATIONS ARE APPROXIMATE ONLY AND SUBJECT TO CHANGE AS PROJECT DESIGN IS FINALIZED

ADDITIONAL EASEMENTS FOR UTILITY RELOCATIONS MAY BE REQUIRED BEYOND THE PROPOSED RIGHT-OF-WAY SHOWN ON THESE PLANS.

R.Z.TUCKER
DARA B.TUCKER
 DB 383 PG 321
 186.62 AC
 TM# 42-A-66

REVISED	STATE	STATE	SHEET NO.
	VA.	ROUTE 15	
VDOT Location & Design Lynchburg, Virginia ROADWAY ENGINEER		VDOT Location & Design Lynchburg Virginia HYDRAULIC ENGINEER	
DESIGN FEATURES RELATING TO CONSTRUCTION OR TO REGULATION AND CONTROL OF TRAFFIC MAY BE SUBJECT TO CHANGE AS DEEMED NECESSARY BY THE DEPARTMENT			

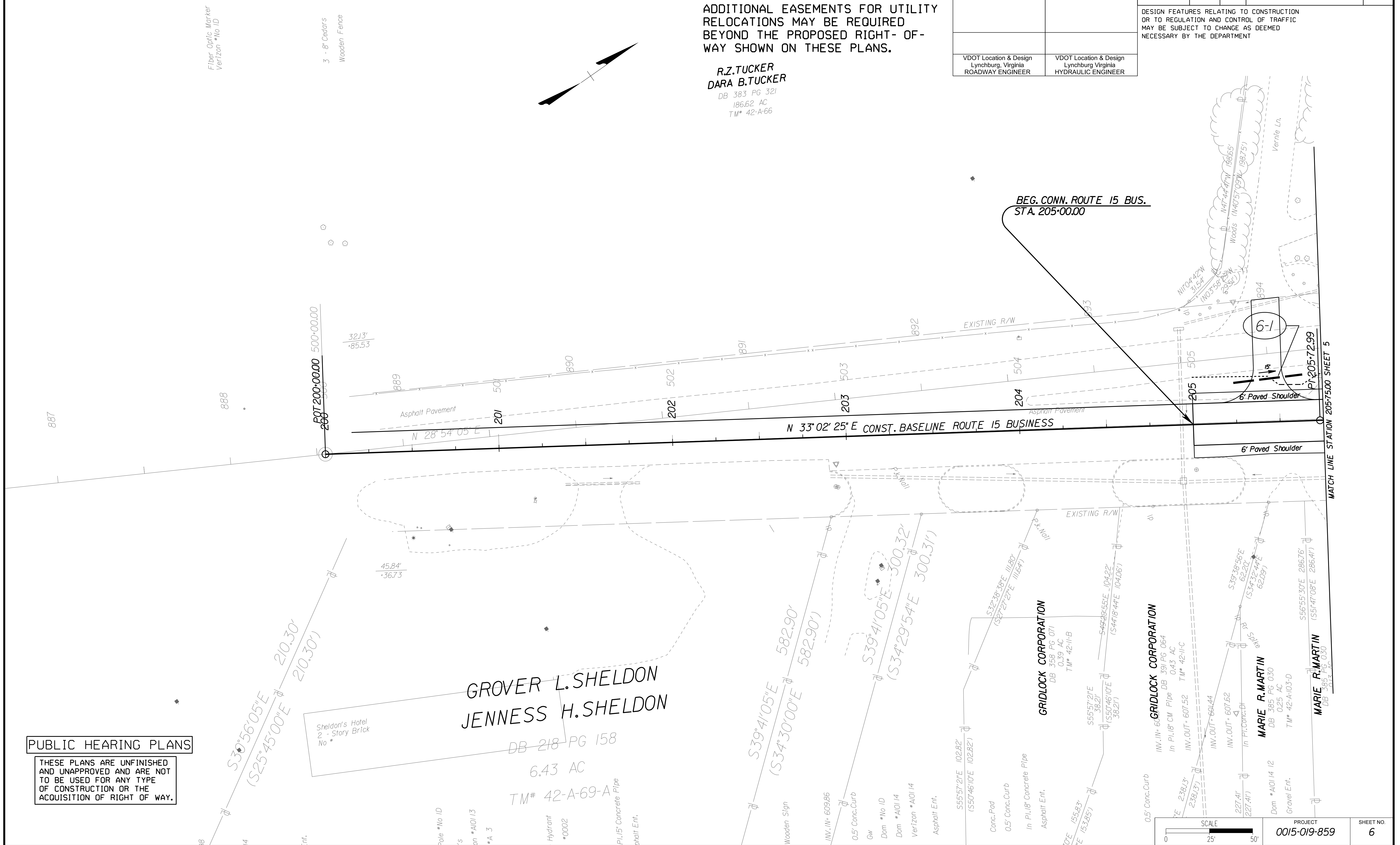

PUBLIC HEARING PLANS

THESE PLANS ARE UNFINISHED AND UNAPPROVED AND ARE NOT TO BE USED FOR ANY TYPE OF CONSTRUCTION OR THE ACQUISITION OF RIGHT OF WAY.

PROJECT MANAGER **Anthony Revelle (434) 856-8258**
 SURVEYED BY, DATE **Rayford T. Clark, LS (434) 856-8262**
 DESIGN BY **Daniel J. Brown, PE (434) 856-8265**
 SUBSURFACE UTILITY BY, DATE **Rayford T. Clark, LS (434) 856-8262**
 LYNCHBURG DISTRICT DESIGN UNIT

TYPICAL SECTIONS

REVISED	STATE	ROUTE	STATE PROJECT	SHEET NO.
	VA.	15	0015-019-859 P101, C501	2A

DESIGN FEATURES RELATING TO CONSTRUCTION OR TO REGULATION AND CONTROL OF TRAFFIC MAY BE SUBJECT TO CHANGE AS DEEMED NECESSARY BY THE DEPARTMENT

PUBLIC HEARING PLANS

THESE PLANS ARE UNFINISHED AND UNAPPROVED AND ARE NOT TO BE USED FOR ANY TYPE OF CONSTRUCTION OR THE ACQUISITION OF RIGHT OF WAY.

VDOT Lynchburg District
Lynchburg, Virginia
ROADWAY ENGINEER

VDOT Lynchburg District
Lynchburg, Virginia
MATERIALS ENGINEER

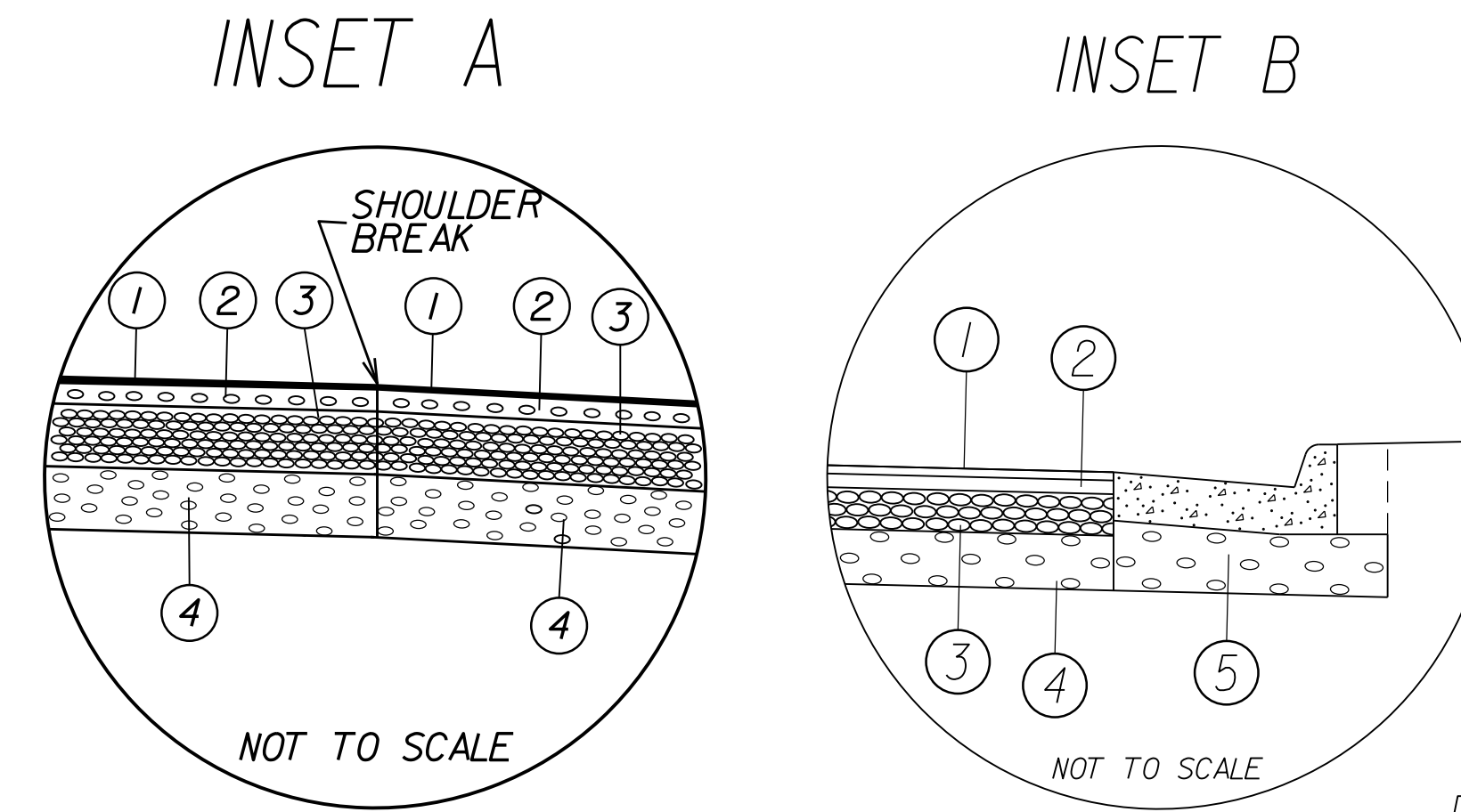
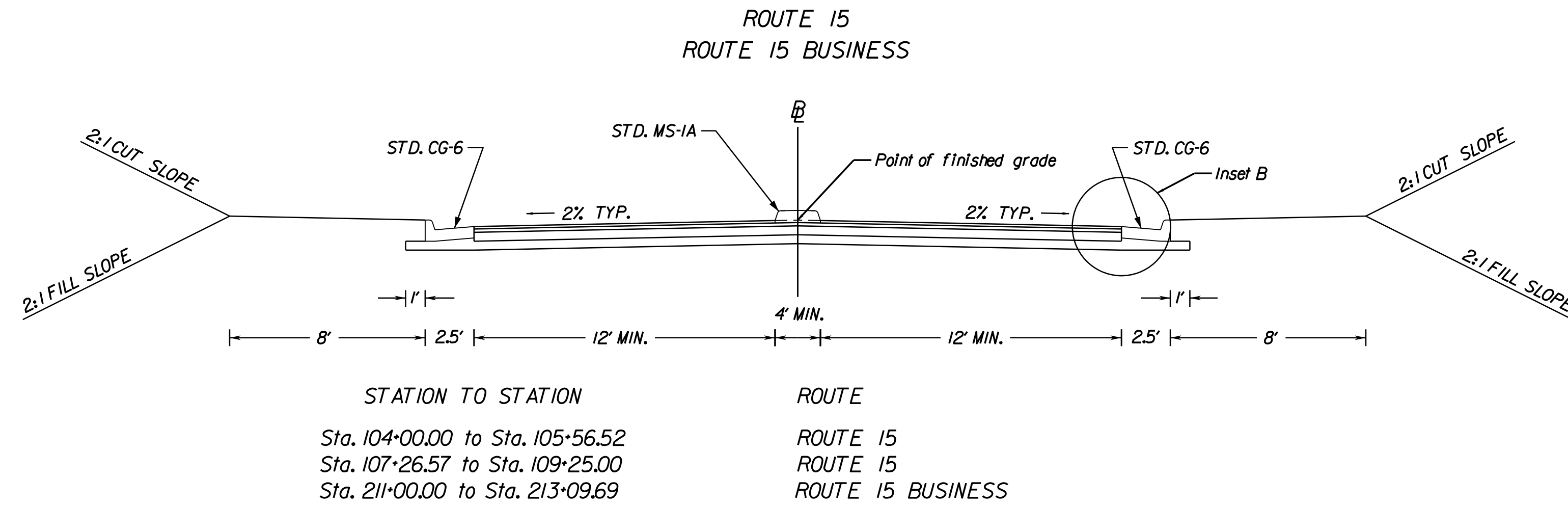

PRIVATE AND COMMERCIAL ENTRANCES

TYPICAL SECTION NOTES:

- ASPHALT CONCRETE SURFACE COURSE TY. SM-9.5D (USE 180 LBS/SY FOR QUANTITY COMPUTATIONS)
- ASPHALT CONCRETE INTERMEDIATE COURSE TY. IM-19.0D (USE 220 LBS/SY FOR QUANTITY COMPUTATIONS)
- 6.5" ASPHALT CONCRETE BASE COURSE TY. BM-25.0A (USE 735 LBS/SY FOR QUANTITY COMPUTATIONS)
- 7" AGGREGATE BASE MATERIAL TYPE I, VA SIZE NO. 21B (USE 147 LBS/CF PLUS 6% MOISTURE CORRECTION QUANTITY COMPUTATIONS)
- VARIABLE DEPTH (2.5" MIN.) AGGREGATE BASE MATERIAL TYPE I, VA SIZE NO. 21B (USE 147 LBS/CF PLUS 6% MOISTURE CORRECTION QUANTITY COMPUTATIONS)

TYPE I
Crusher Run Aggr.

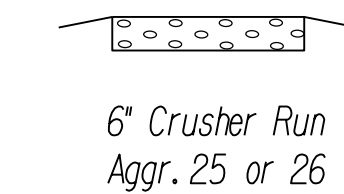

TYPE II
Concrete

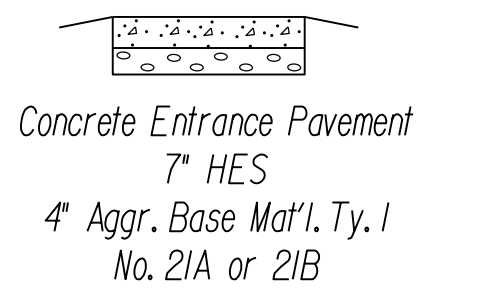

TYPE III
Asphalt

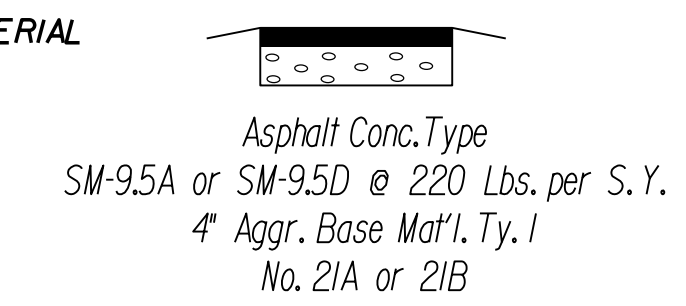

NOT TO SCALE

TYPE IV
Asphalt Commercial

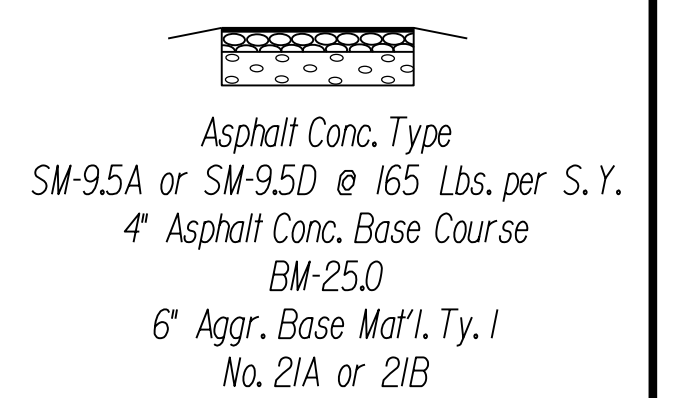

The type of entrance (I, II, III, IV) to be constructed will be determined by the existing condition at the time of construction.

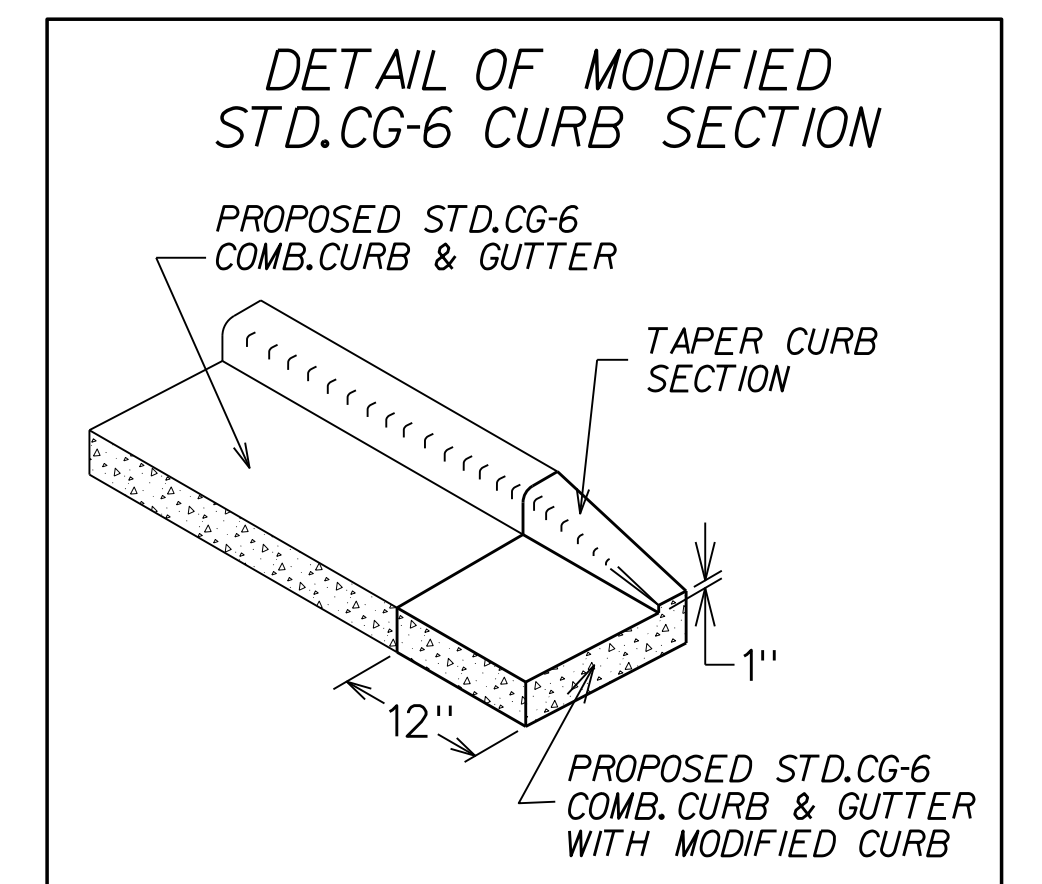
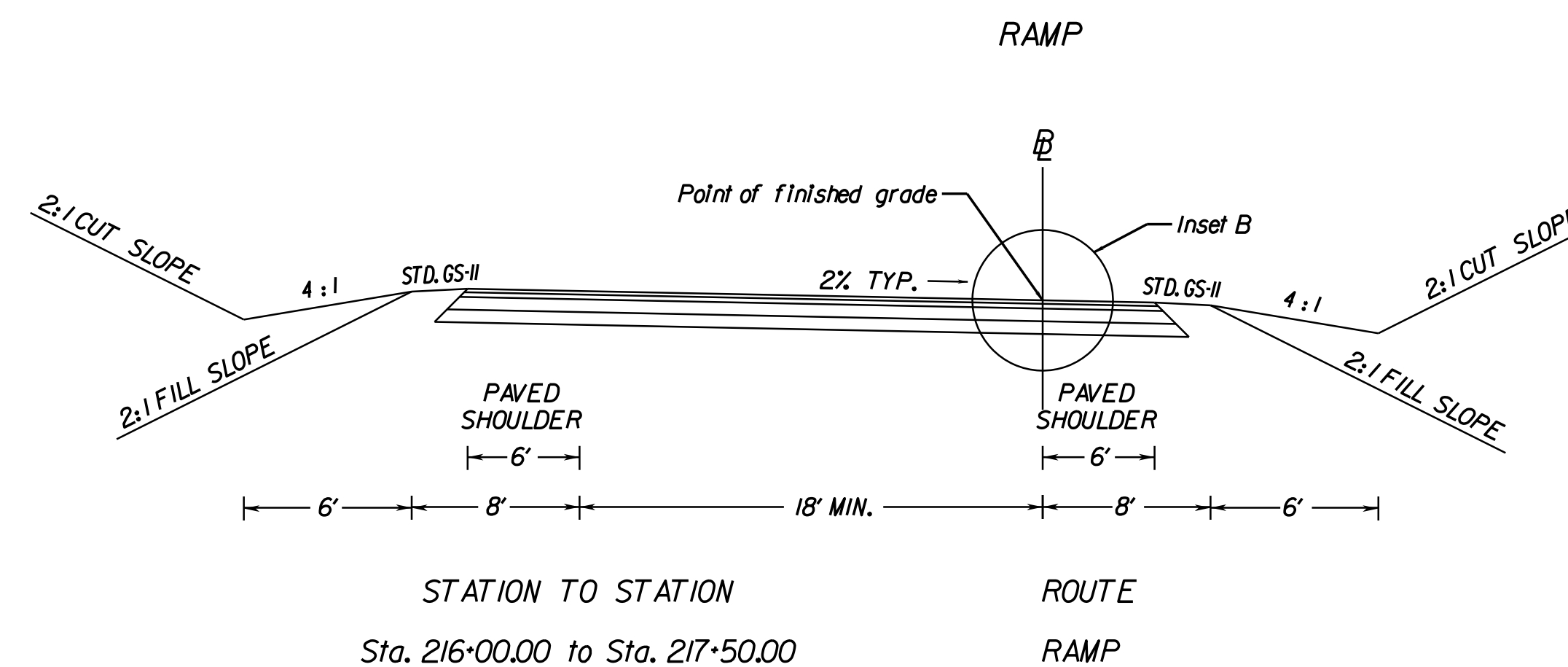
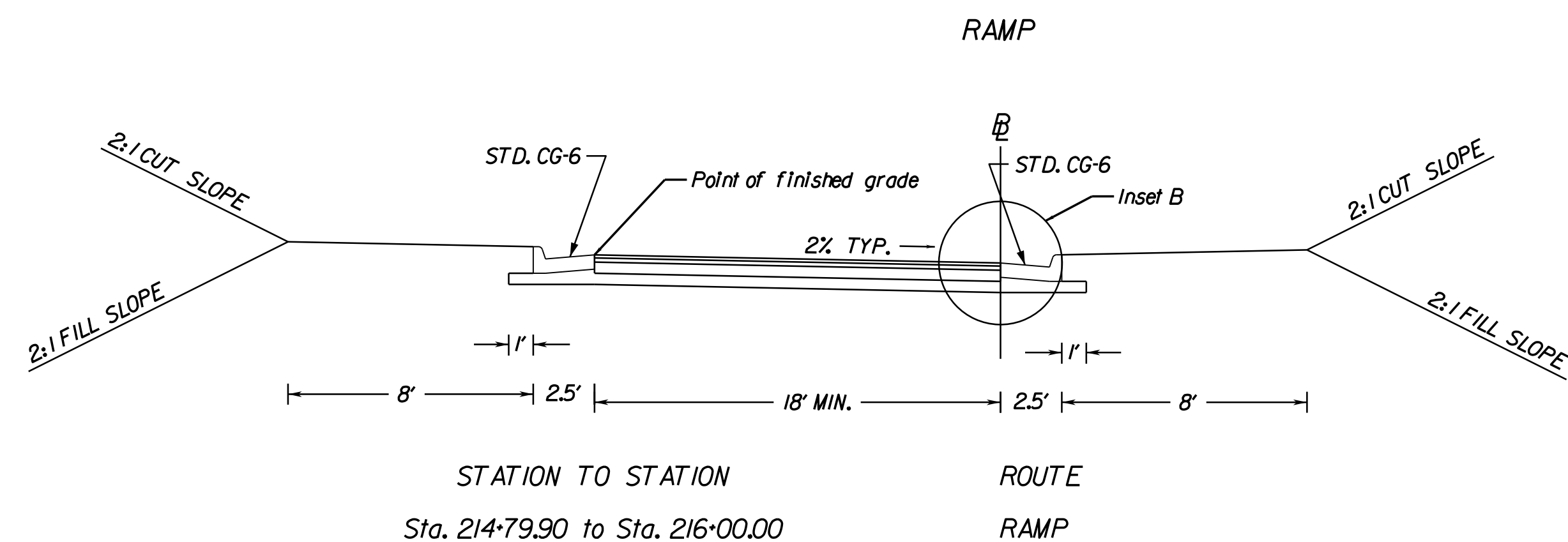
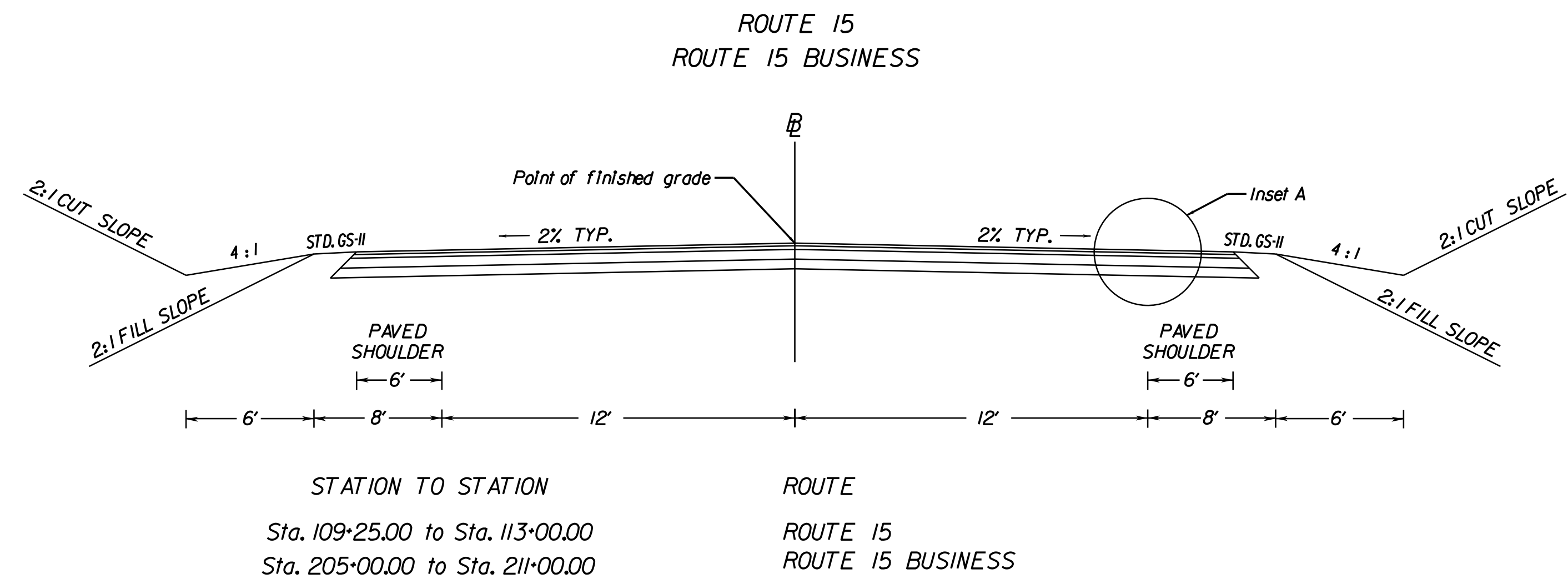

PROJECT MANAGER **Anthony Revelle (434) 856-8258**
 SURVEYED BY, DATE **Rayford T. Clark, LS (434) 856-8262**
 DESIGN BY **Daniel J. Brown, PE (434) 856-8265**
 SUBSURFACE UTILITY BY, DATE **Rayford T. Clark, LS (434) 856-8262**
 LYNCHBURG DISTRICT DESIGN UNIT

TYPICAL SECTIONS

REVISED	STATE	STATE		SHEET NO.
	VA.	ROUTE 15	PROJECT 0015-019-859 PIOI, C50I	
DESIGN FEATURES RELATING TO CONSTRUCTION OR TO REGULATION AND CONTROL OF TRAFFIC MAY BE SUBJECT TO CHANGE AS DEEMED NECESSARY BY THE DEPARTMENT				
VDOT Lynchburg District Lynchburg, Virginia ROADWAY ENGINEER		VDOT Lynchburg District Lynchburg, Virginia MATERIALS ENGINEER		

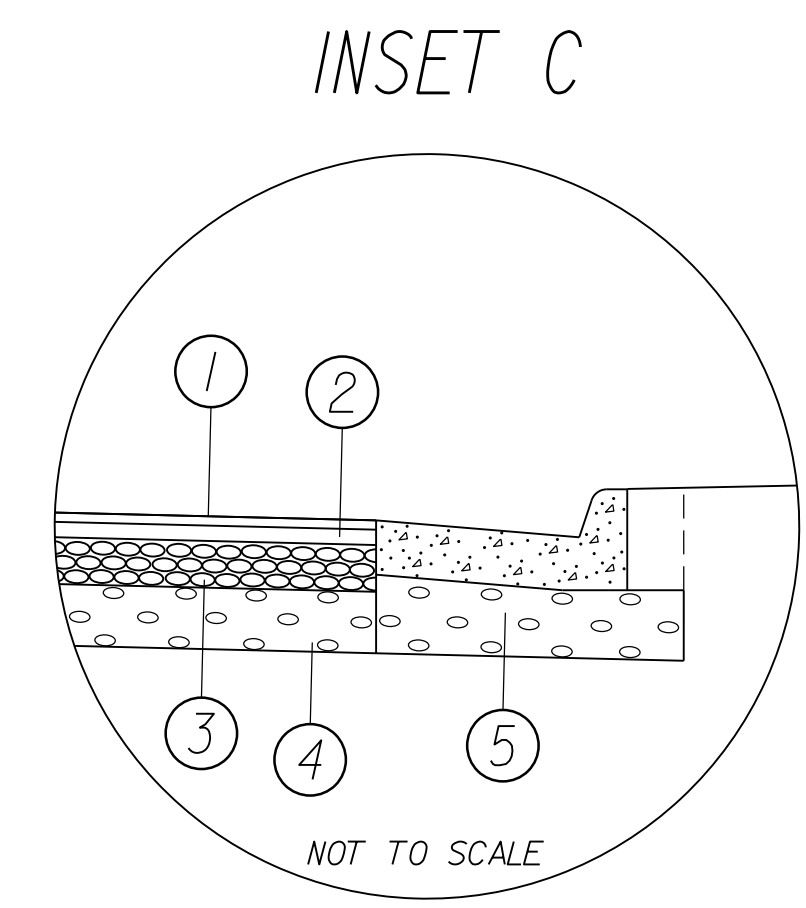
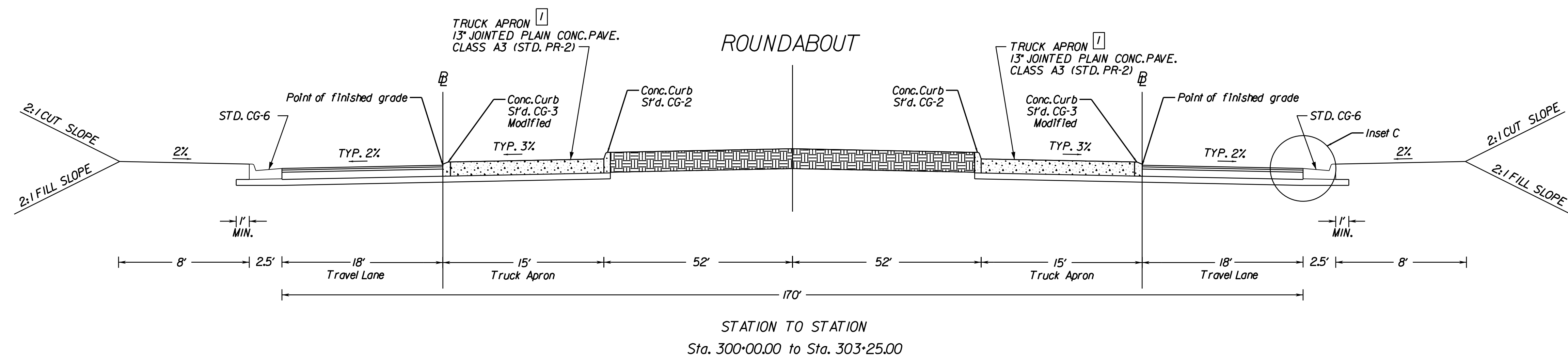

- TYPICAL SECTION NOTES:**
- ① ASPHALT CONCRETE SURFACE COURSE TY. SM-9.5D (USE 180 LBS/SY FOR QUANTITY COMPUTATIONS)
 - ② ASPHALT CONCRETE INTERMEDIATE COURSE TY. IM-19.0D (USE 220 LBS/SY FOR QUANTITY COMPUTATIONS)
 - ③ 6.5" ASPHALT CONCRETE BASE COURSE TY. BM-25.0A (USE 735 LBS/SY FOR QUANTITY COMPUTATIONS)
 - ④ 7" AGGREGATE BASE MATERIAL TYPE 1, VA SIZE NO. 21B (USE 147 LBS/CF PLUS 6% MOISTURE CORRECTION QUANTITY COMPUTATIONS)
 - ⑤ VARIABLE DEPTH (2.5" MIN) AGGREGATE BASE MATERIAL TYPE 1, VA SIZE NO. 21B (USE 147 LBS/CF PLUS 6% MOISTURE CORRECTION QUANTITY COMPUTATIONS)

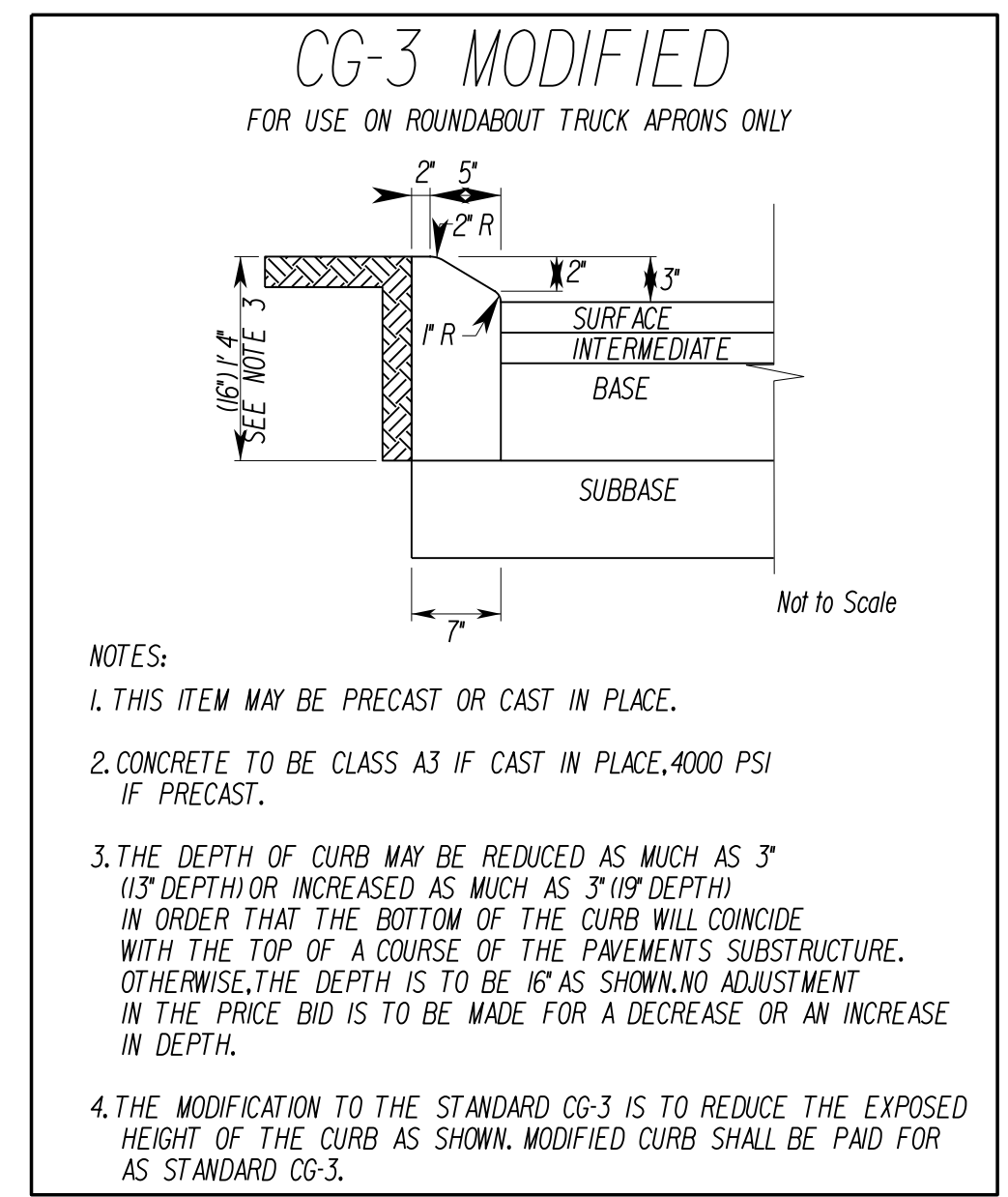
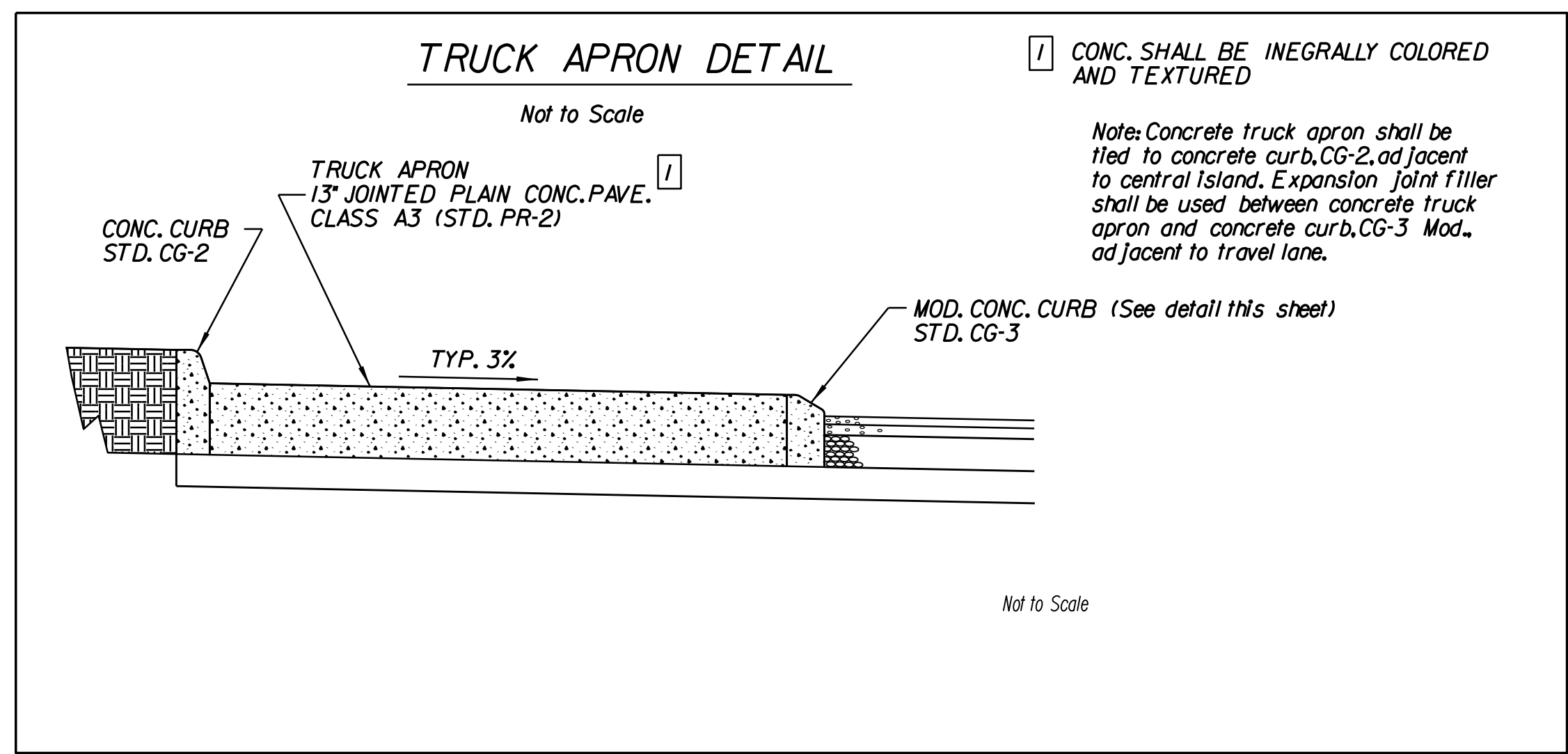

PUBLIC HEARING PLANS

THESE PLANS ARE UNFINISHED AND UNAPPROVED AND ARE NOT TO BE USED FOR ANY TYPE OF CONSTRUCTION OR THE ACQUISITION OF RIGHT OF WAY.